

System SILENCE LOFT



Rw up to 53 dB



Profiles and muntin bars painted in any RAL colour



Industrial style



The SILENCE LOFT system is an industrial aluminium and glass solution that can be easily customised to suit a range of design requirements. The painting of profiles and muntins in any RAL colour and the option of using a smart LCD film with variable translucency allow the walls to be designed to be functional and to match the style of the entire interior. The system is defined by profiles that are 25 mm or 30 mm high and 78 mm deep, as well as high acoustic parameters reaching Rw 53 dB. A wall in the SILENCE LOFT system can reach a height of up to 4036 mm.

Double or single-glazed system

Structural profiles 25 or 30 mm high
and 78 mm wide in any colour from the RAL palette

Maximum height 4036 mm

Aesthetic and minimalist design

A possibility to install both horizontal and
vertical mullions

National Technical Assessment: ITB-KOT-2019/1191

European Technical Assessment: ETA- 20/0885

System Silence Loft
Vertical

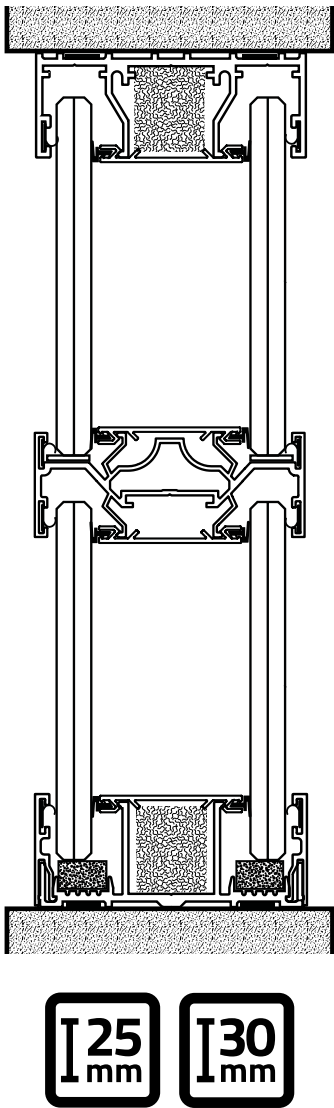

System Silence Loft
Horizontal

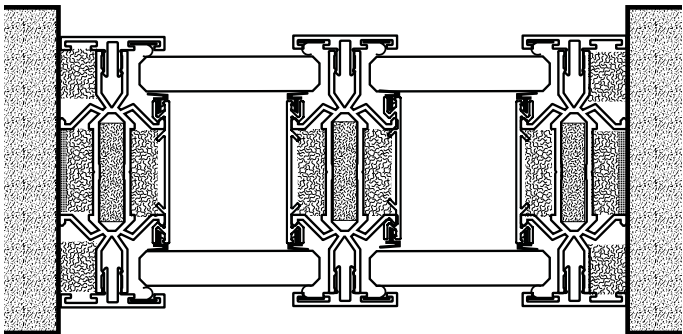

System Silence Loft with doorframe
Horizontal

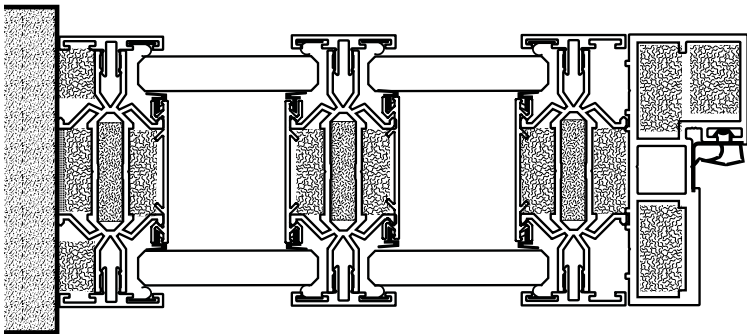

System Silence Loft
Type of filling

Glazing	VSG 33.1 + VSG 33.1	VSG 33.1 + VSG 55.1	ESG 12 + ESG 12	VSG 44.2 + VSG 44.2 + Acoustic insert	VSG 55.2Si + VSG 66.2Si	VSG 66.2Si + VSG 66.2Si + Acoustic insert
Acoustic insulation Rw	40dB	43 dB	44 dB	46 dB	48 dB	52 dB
Filling	2x VSG 66.2Si + Mineral wool + Acoustic insert					
Acoustic insulation Rw	53 dB					