

System

SILENCE LOFT FS



Rw up to 47 dB



System with
muntins



Fire resistance
EI30/EW30



The SILENCE LOFT FS system is a distinctive solution that combines an elegant appearance with robust fire safety features. The double-glazed structure, with perimeter profiles 30 mm high (height of muntin profiles 38 mm) and 78 mm deep, offers fire resistance EI30/EW30, while the versatility of the muntin arrangement allows for unique designs. The SILENCE LOFT FS also boasts of high acoustic parameters, reaching Rw 47 dB, making it an ideal choice for applications where comfort of work or rest is important.

Double-glazed muntin system

Structural profiles 30 mm high and 78 mm thick

Maximum height 3100 mm

Fire resistance EI30/EW30

Aluminium profiles painted in any RAL colour

Open or closed frame profiles, surface or concealed hinges

Profiles for mounting of cables - for light switches
and telecommunications sockets

National Technical Assessment: ITB-KOT-2022/2089

System Silence Loft FS

Vertical



reddot winner 2021

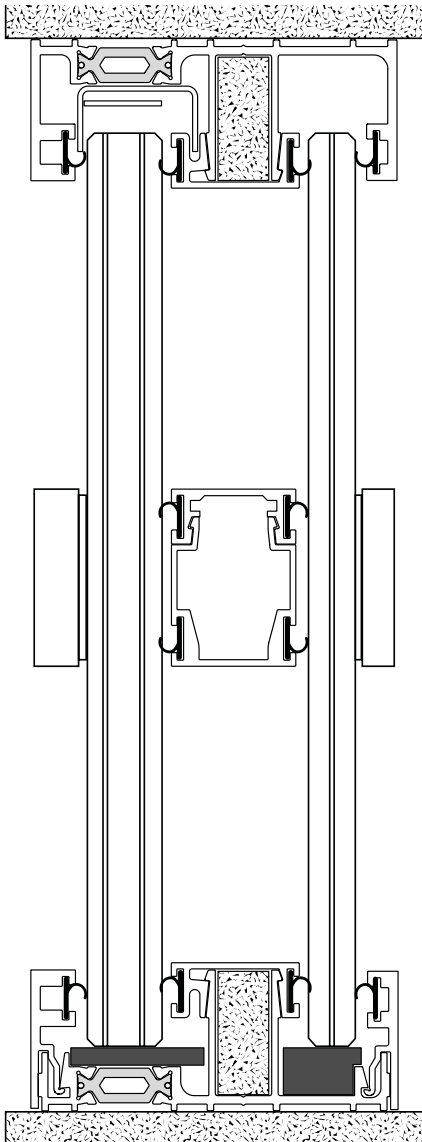

System Silence Loft FS with doorframe

Horizontal

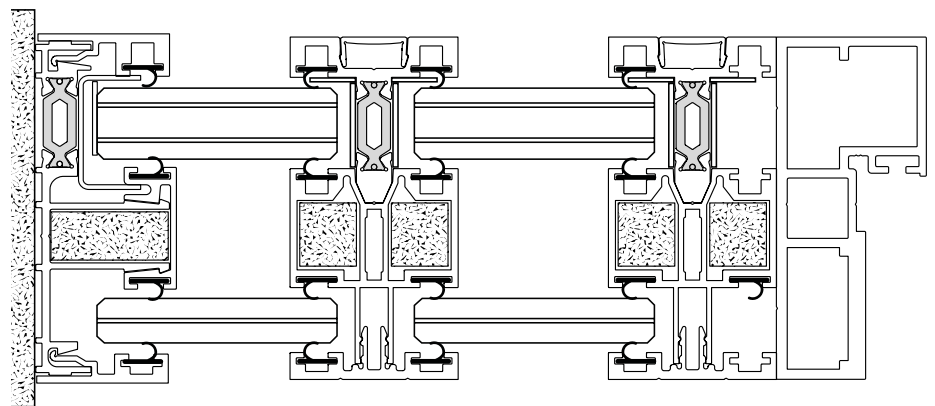

System Silence Loft FS

Type of filling

Glazing	Contraflam 30 + VSG 55.1	Contraflam 30 + VSG 66.2Si	AGC Pyrobel 16 + VSG 55.1	AGC Pyrobel 16 + VSG 66.2Si
Acoustic insulation Rw	42 dB	47 dB	45 dB	46 dB